



## INSTALLATION GUIDELINES

# RASCOTight Hydrophilic Channel

### GENERAL

To obtain a completely waterproof construction (without injections), the re-injectable hydrophilic channels must be installed so, that they provide a closed system, without gaps.

### PERSONAL PROTECTIVE EQUIPMENT

- Wear suitable protective gloves and goggles



### STANDARD INSTALLATION LAYOUT

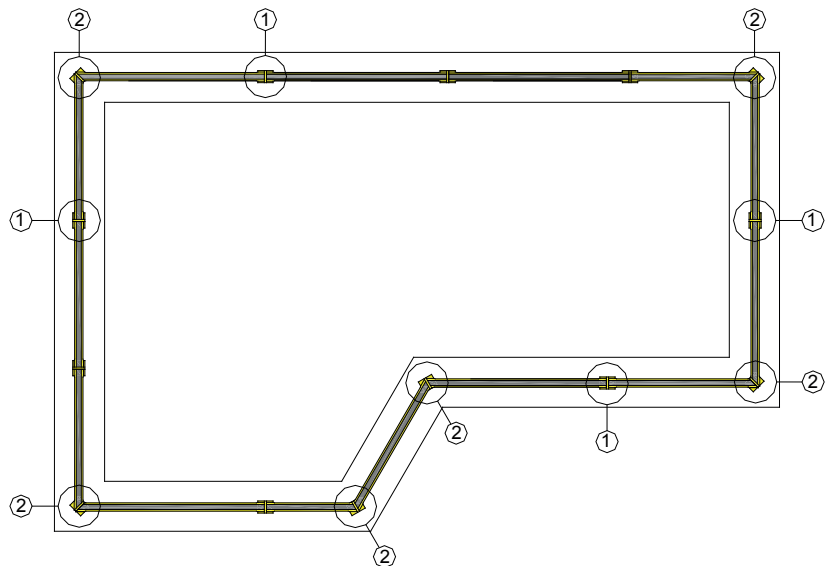

### INSTALLATION ARRANGEMENT

- Wall with  $< 400$  mm at the centre line
- Wall with  $> 400$  mm 200 mm offset from injection side

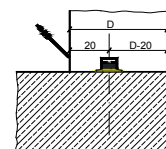
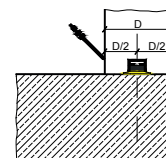

Z000616D

## FIXING

- Place RASCOTight channel only on broom cleaned surface
- Drill all marked wholes with a 6 mm drill
- Fix with RASCOfix nail plug

## BUTTED JOINT

- Push connecting piece solidly to the channels end
- Last fixing in the area of the connecting piece

- Place next channel tightly against
- First fixing in the area of the connecting piece

## CORNER/ANGLE CONNECTION

- Mitre channel as needed
- Push connecting piece solidly to the channels end

- Last fixing in the area of the connecting piece
- Place next channel tightly against the connecting piece
- First fixing in the area of the connecting piece

## SLAB/WALL ANGLE JOINTS

- Tightly butt channel against hydrophilic connector
- Fix horizontal channel
- Tightly butt vertical channel against hydrophilic connector
- Position first fixing at hydrophilic connector

## TRANSITION FROM SLAB/WALL TO WALL/WALL JUNCTION

- Cut off one flange of hydrophilic connector
- Place angle piece of hydrophilic material on channel
- Tightly butt vertical channel against angle piece
- Position first fixing at hydrophilic connector

